

AP MORGAN



Tenbury Close, Redditch
Offers in the region of £165,000

Features:

- Two Bedroom Semi Detached Maisonette
- Quiet Cul De Sac Location
- Front Driveway
- Great Condition Throughout
- Spacious Lounge
- Landscaped Rear Garden
- Ideal For First Time Buyer
- Church Hill North District of Redditch

Description:

Situated in a quiet cul-de-sac location is this well-presented two-bedroom maisonette.

The property is approached via allocated parking, providing convenience for residents and visitors alike.

Once inside, the welcoming interior briefly comprises: an entrance porch leading into a bright and spacious lounge, perfect for relaxing or entertaining. The fitted kitchen offers ample cupboard and worktop space, with room for essential appliances. From the central hall, you'll find two well-proportioned bedrooms, including a generous main bedroom and a versatile second bedroom ideal for guests, a home office, or hobby space. The bathroom is fitted with a modern suite, and a useful built-in cupboard provides additional storage.

With a total floor area of approximately 59.2 sq. metres (637.6 sq. feet), this low-maintenance home offers comfortable living in a peaceful yet well-connected setting, making it ideal for first-time buyers, investors, or those looking to downsize.

Viewing is highly recommended to appreciate the layout, location, and lifestyle on offer.

Ideally positioned, it offers easy access to local amenities, a variety of shops, and excellent road links, as well as the scenic Arrow Valley Country Park for outdoor leisure.



Details:

Lounge 18'9" x 10'10" (5.72m x 3.3m) Both Max

Kitchen 12'3" x 7'10" (3.73m x 2.4m)

Bedroom 1 14' x 9'7" (4.27m x 2.92m) Both Max

Bedroom 2 11'2" x 9'7" (3.4m x 2.92m) Both Max

Bathroom 9'5" x 5'8" (2.87m x 1.73m)



EPC Rating: C

Council Tax Band: B (tbc by solicitors).

Tenure: Leasehold (tbc by solicitors).

For more information or to arrange a viewing, please call us on 01527 406 956.



How can we help you?

Need a mortgage?

We recommend Wisser Mortgage Advice. They will search the market for you to ensure you get the right lender and mortgage deal. They typically achieve mortgage offers much more quickly than if you were dealing with lenders directly. The initial appointment is free and without obligation. Call us on 01527 406 956, or visit their website for more information: www.wissermortgageadvice.co.uk

Property to sell?

If you need to sell a property in order to buy, you ideally need to be on the market at least (and preferably Sold STC) before viewing, otherwise you may lose out to other buyers when the right property comes along. In these circumstances we can get your property 'live' quickly. Just book a free valuation and we will visit your property and discuss your needs.

Need a solicitor?

A good solicitor can save you literally weeks of time in the buying/selling process, reducing the stress levels of all involved. We will instruct a reputable firm that is competitive on cost and very reliable. Just ask for a quote.

Identity Checks

Estate Agents are required by law to conduct anti-money laundering checks on all those buying a property. We have partnered with a third party supplier to undertake these who will contact you once you have had an offer accepted on a property you wish to buy. The cost of these checks is £39 + VAT per buyer and this is a non-refundable fee. These charges cover the cost of obtaining relevant data, any manual checks and monitoring which might be required. This fee will need to be paid and the checks completed in advance of the issuing of a memorandum of sale on the property you would like to buy.

No statement in these details is to be relied upon as representation of fact, and purchasers should satisfy themselves by inspection or otherwise as to the accuracy of the statements contained within. These details do not constitute any part of any offer or contract. AP Morgan and their employees and agents do not have any warranty or representation whatsoever in respect of this property. These details and all statements herein are provided without any responsibility on the part of AP Morgan or the vendors. Equipment: AP Morgan has not tested the equipment or central heating system mentioned in these particulars and the purchasers are advised to satisfy themselves as to the working order and condition. Measurements: Great care is taken when measuring, but measurements should not be relied upon for ordering carpets, equipment, etc. The Laws of Copyright protect this material. AP Morgan is the Owner of the copyright. This property sheet forms part of our database and is protected by the database right and copyright laws. No unauthorised copying or distribution without permission.

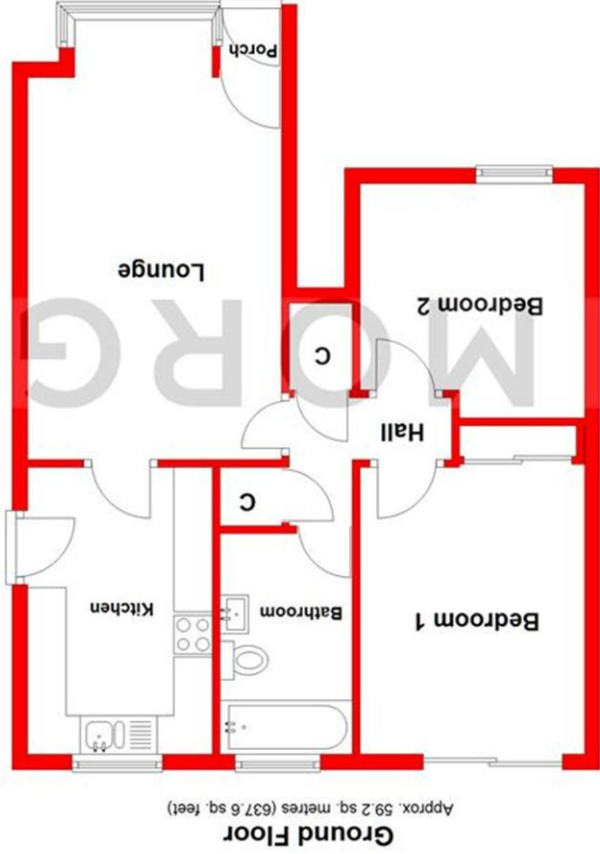

Total area: approx. 59.2 sq. metres (637.6 sq. feet)

Whilst every attempt has been made to ensure the accuracy of the floorplan contained here, measurements of doors, windows, rooms, and any other items are approximate and no responsibility is taken for any error, omission or mis-statement. This plan is for illustrative purposes only and should be used as such by any prospective purchaser. The services, systems and appliances shown have not been tested and no guarantee as to their operability or efficiency can be given.

Plan produced using PlanUp.